

HEMOMATIK Sweden

Liquid level switch

Art.nr. HMCHI-OO

O=..... mm

Drawing nr. HMCHI-OO

Rev. 4

Approved P.L.140630

Scale 1:2

O=..... mm

Date 951215

Sign. MEM

Rev. date 140630

For switchpointsmm, see label
Label applied by user.



Ground

3 1 2



Rights to the design and drawing belongs to HEMOMATIK Sweden, copyright ©

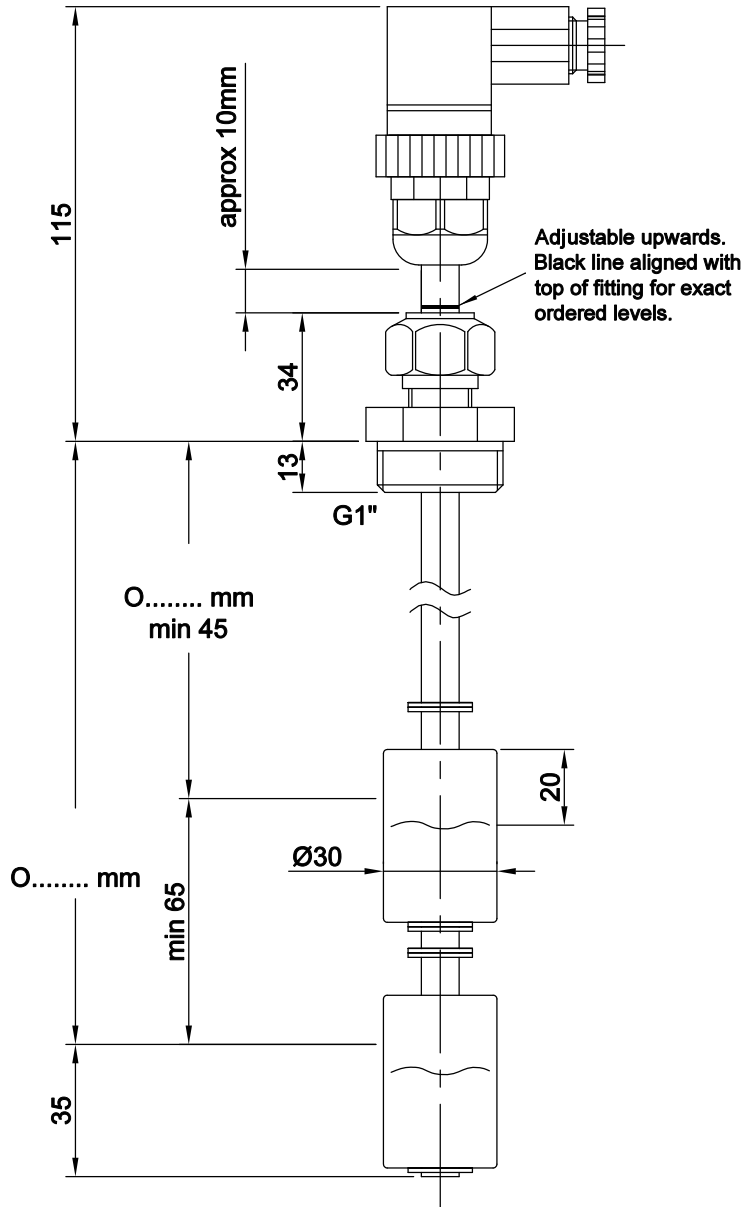

FEATURES

Float liquid level sensor with REED-technology to activate pumps or valves via relays or PCs. Recommended for oil and petroleum fluids.

MATERIALS

Stem : Brass
Float : Buna-N. S.G. 0,3
Fitting : Brass
Connector : DIN 43650
Temp. media : -20...+100°C
Temp. ambient : -20...+70°C

CONTACT SYMBOLS

S = means NC low, NO going upwards
O = means NO low, NC going upwards
V = change over

INSTALLATION

Compression fitting is delivered not tightened.
Decide and adjust level, once the nut is tightened the compression ring is firm on the stem.

ELECTRICAL DATA

Contact rating *	70 VA
Supply voltage	3-230 VAC/DC
max current	1,5 A

* = resistive load
No ground = max 50 V

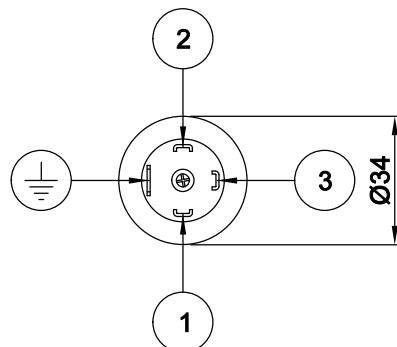

Note. Above values are for resistive loads.
Mechanical life is 30 millions.
Use series resistor for lamp load, or other suitable protection for inductive loads if the rating is higher than 1/10 of the values above.

■ = Switch closed

□ = Switch open